

# Can BV cables be run naked through cable trays



## Overview

Due to their exposure to the open air because of the cable trays, the wires contained within need a very durable outer covering. The regulations dictate that the cables must either be Type TC (also known as Tray Rated) or must be metal-armored (Type MC). Cable tray is the preferred wiring method for industrial facilities, data centers, and large commercial buildings where routing dozens or hundreds of cables through individual conduits would be impractical and expensive. NEC Article 392 governs cable tray installations, covering tray types, fill. According to the 2005 National Electrical Code® (NEC), a cable tray system is “ unit or assembly of units or sections and associated fittings forming a structural system used to securely fasten or support cables and raceways. This is a description of how to select, install, and support these metal or plastic frames, on which electrical wires are installed. You should consider it as a series of instructions that make the buildings resistant to. Installation of Cable in Cable Trays involves precise routing on support systems, NEC/IEC compliance, grounding, ampacity derating, bend radius control, segregation of services, fire safety, labeling, and reliable cable management for industrial and commercial facilities. Think of a roadway

bridge that supports traffic. Cable Tray Systems must provide protection to life & property against faults caused by electrical disturbances Lighting. Question 1: Can mechanical utility piping or tubing containing water or compressed air be installed in cable trays with electrical cables?

Answer: No. NEC section 300-8 does not permit.

## Can BV cables be run naked through cable trays



The stresses of pulling large cables through cable trays can produce 3 times the stress of the cables' static load. If the installation load is not evaluated the cable tray may be damaged during installation.



It should be mounted far enough off the floor or roof to allow the cables to exit through the bottom of the cable tray. If a strut is used for this purpose, mount the strut directly to the floor or roof and attach the ...

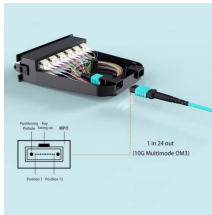

If visual observation reveals a cable tray that is completely full and/or over-flowing with cables, chances are that the cable tray is in violation of both the National Electrical Code and OSHA requirements.



Cables and conductors must be secured to the cable tray at intervals according to installation instructions. For non-horizontal runs, cables should be fastened securely to transverse ...



Question 1: Can mechanical utility piping or tubing containing water or compressed air be installed in cable trays with electrical cables? Answer: No. Cable trays are a support system for electrical cables, ...



Cable tray layout must take into consideration the design limits of the cable. To minimize damage and verify integrity after installation, follow the practices outlined in cable handling and testing procedures ...



Can any cable be used in a tray? The short answer is no. Due to their exposure to the open air because of the cable trays, the wires contained within need a very durable outer covering.



This guide covers the cable tray types and their appropriate applications, the fill rules for each configuration, ampacity derating requirements, separation of power and signal cables, and the ...

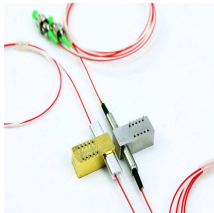

This guide covers the critical steps, from selecting the right electrical cable tray and performing accurate cable fill calculations to managing a safe cable pull through and ensuring all bonding and grounding ...



If an employee is performing work that could damage the insulation, such as adding boxes or other approved electrical equipment using screws or bolts, drilling into the cable tray, and pulling cables or ...

## Contact Us

For more information, pricing, or custom data center solutions, please contact us:

Website: <https://yoahorroenergia.es>

Email: [hello@yoahorroenergia.es](mailto:hello@yoahorroenergia.es)

Phone: +233 54 318 7269

Address: Plot 28, Spintex Road, Accra, Greater Accra, Ghana

This document is for informational purposes only. Specifications subject to change without notice.

