

## Dimensions of Fiber Optic Cable Relay Frames for Cloud Computing

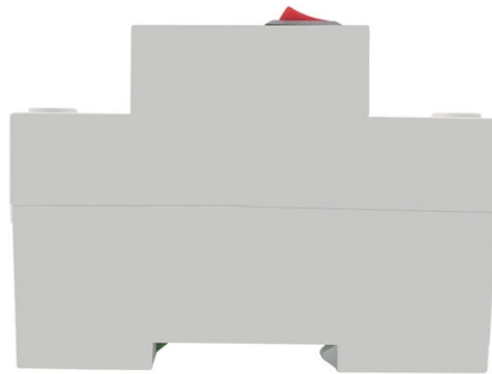

### Overview

ODFs come in different configurations depending on deployment requirements: Wall-Mount ODF: Compact units suitable for telecom rooms or small setups. Rack-Mount ODF: Standard 19-inch or 23-inch frames for high-density data center deployments. Modular ODF: Scalable systems for growing. The Centrix™ System is a high-density fiber management system that provides a balance of industry-leading density with innovative jumper routing. Floor or wall mounted relay racks typically are offered in 2 or 4 post configurations with a variety of secondary features available. This lightweight rack is made of aluminum and has 19" or ETSI profiles that allow flexible height adjustment when you install an ODF system. It includes the metallic casing, adapter plate, splice tray and other necessary materials for the termination of. Optical distribution frames (ODFs) are an all-important network element at the heart of a fiber network. Representing less than 5% of a typical IT project investment, high density, performance, and quality are pivotal attributes for an ODF ensuring business continuity 24 hours a day, seven days a week.

## Dimensions of Fiber Optic Cable Relay Frames for Cloud Computing



These features offer varying degrees of access, protection, footprint size and support for mounted equipment. Standard relay racks and cabinets have vertical posts that are spaced at either 19" or 23" ...



Built with modular MPO connectivity, these cable assemblies allow for rapid deployment of high-density permanent links in a single assembly for data center applications requiring quick infrastructure ...

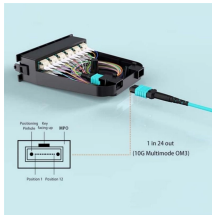

Cables can be routed into the frame from either the top or bottom, depending on specific installation requirements. Suitable for both loose bundle and ribbon-type cables. Equipped with a secure cable ...



A Complete Guide to Optical Distribution Frames (ODFs) for Modern Fiber Networks This complete guide explores everything you need to know about ...



Explore optical distribution frames (ODF) with efficient distributed chassis solutions at CommScope



Centrix System supports up to 4,320 LC or 2,880 SC connector ports per standard 7-ft frame/2200 mm. The frame design provides optimized routing paths for jumpers, reducing the risk of pileup or ...



It is available from 1U, 2U, 3U and 4U dimensions. The Fiber Distribution Frame is made from corrosion resistance material and robust construction and shall allow both top or bottom entry for access to this ...



The Flexi Rack series is specially designed for termination and management of many fiber cords. This lightweight rack is made of aluminum and has 19" or ETSI profiles that allow flexible height ...



The 19" rails and the cable routing mandrels are numbered, lettered and colour-coded for clear placement of hardware and accessories. The cable connections of four height units can be guided ...



A Complete Guide to Optical Distribution Frames (ODFs) for Modern Fiber Networks This complete guide explores everything you need to know about ODFs — from their structure, types, and ...



Comprehensive guide to Optical Distribution Frames (ODF) for data centers. Learn ODF types, installation best practices, fiber management, patch panels, MPO/MTP solutions, and high ...

## Contact Us

For more information, pricing, or custom data center solutions, please contact us:

Website: <https://yoahorroenergia.es>

Email: [hello@yoahorroenergia.es](mailto:hello@yoahorroenergia.es)

Phone: +233 54 318 7269

Address: Plot 28, Spintex Road, Accra, Greater Accra, Ghana

This document is for informational purposes only. Specifications subject to change without notice.

