

How much current does a 4-core single-mode optical fiber draw

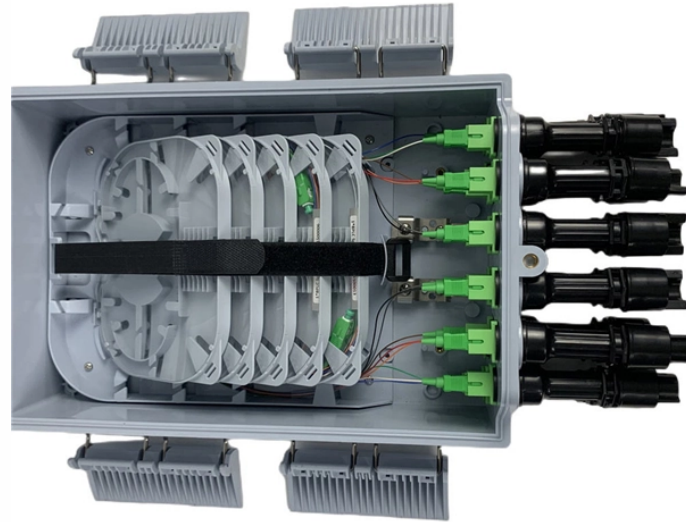

Overview

This calculator helps determine the output power of an optical fiber given its length, attenuation, and input power. It provides calculations for both dBm and mW. Modes are the possible solutions of the Helmholtz equation for waves, which is obtained by combining. An ultrafast laser pulse can have peak power of around 10 15 watts, and will happily go down an optical fibre if you spread it in directions orthogonal to the beam such that it has low enough intensity to avoid destroying the fibre. This might require a slightly wider core than standard, but is. Single-mode fiber optic cables single-mode fiber optic cables 1 have a small core, typically around $9\mu\text{m}$, and are designed to carry signals over long distances at higher bandwidths. They have a central core surrounded by a concentric cladding with slightly lower (by $\approx 1\%$) refractive index. Optical fibers are typically made of silica with index-modifying dopants such as GeO 2.

How much current does a 4-core single-mode optical fiber draw



OverviewHistoryCharacteristicsConnectorsFiber optic switchesQuadruply clad fiberExternal links

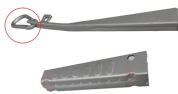

Whether you are an IT specialist, a network manager, or just a curious individual interested in the technology that interconnects the world, knowing single-mode fiber is fundamental. ...



Radiation modes carry energy out of the core; the energy is quickly dissipated. Guided modes are confined to the core, and propagate energy along the fiber, transporting information and power. If the ...



I don't know exactly how much power they can carry, but hollow core fibers are pretty good at it, as the beam is almost not touching the glass but the gas inside, and gases are highly resistant to optical ...



Waves can have the same mode but have different frequencies. This is the case in single-mode fibers, where we can have waves with different frequencies, but of the same mode, which means that they ...



Our comprehensive guide to types of fiber optic cables. Learn all about the differences between single mode and multimode cables, as well as the various fiber wavelengths and standard core sizes used ...

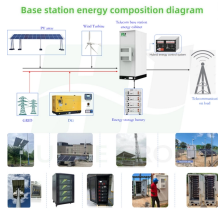

4-Core Single mode Fiber Optic Cable also called 4-core Optical fiber cable, is a type of communications optic cable which has the same transmission speed as light. They are used to ...



Explore the differences between OS1, OS2 (single-mode) and OM1, OM2, OM3, OM4, OM5 (multimode) fibers. Learn their speeds, distances, and ideal uses for data centers and telecom networks.



Explore the essential specifications of single-mode fiber optic cables, including core size, attenuation rates, bandwidth capabilities, and standard classifications like OS1 and OS2. Understand ...



If we were to increase the radius of the single-mode fiber by a factor of 10, we may expect this threshold to increase further to the kilowatt range. However, this is not an ideal situation, as bringing the fiber ...



This calculator helps determine the output power of an optical fiber given its length, attenuation, and input power. It provides calculations for both dBm and mW.

Contact Us

For more information, pricing, or custom data center solutions, please contact us:

Website: <https://yoahorroenergia.es>

Email: hello@yoahorroenergia.es

Phone: +233 54 318 7269

Address: Plot 28, Spintex Road, Accra, Greater Accra, Ghana

This document is for informational purposes only. Specifications subject to change without notice.

