

Provincial Standard Distribution Box Ground Clearance

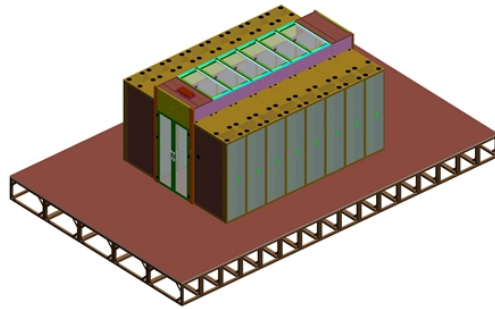

Provincial Standard Distribution Box Ground Clearance



Below are the individual original details. No individual details are available for the 2013 update. Free viewers are required for some of the attached documents. They can be downloaded by clicking on ...



It includes minimum clearances for indoor and outdoor phases, ground clearances, clearances between crossing lines, minimum heights above railways, clearances from buildings, and other spacing ...



Where vegetation to line clearance cannot be readily accessed from the ground but the horizontal and vertical clearance between the vegetation and conductors can be determined from an aerial ...



The purpose of the advisory notice [PDF, 232 KB] is to draw the attention of developers and owners of multiple occupancy buildings, and their electrical consultants and contractors to the ...



All customers on the Utility's electric distribution system are occasionally subjected to momentary fluctuations in serving voltage. These are caused by disturbances such as lighting surges and short ...



For a raptor sensitive location, provide a minimum phase to ground vertical clearance of 41 inches **. Post insulator framing on wood or steel poles is excepted from this clearance requirement.



Entities seeking to install their antenna (s) onto SCE poles shall comply with SCE standards and General Order (G.O.) 95 requirements. To access this manual, click on the manual title below.

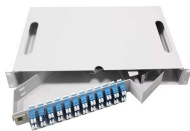

* - THE MULTIGROUNDED SYSTEM NEUTRAL HAS THE SAME CLEARANCE AS THE 600V SYSTEM. ** - THE VERTICAL CLEARANCES IN THE ABOVE TABLE ARE UNDER MAXIMUM ...



Standard tubular material used for mechanical protection of electrical systems which may be exposed, buried beneath the surface of the ground, or encased in a building structure as required.



This standard provided horizontal and vertical clearance requirements between BC Hydro distribution lines and buildings, signs, billboards, lamp and traffic structures, and similar plant.



Upon special permission from this Commission, a minimum clearance of 25 feet above ground may be applied in similar areas to circuits in excess of 30,000 volts, however, not including Class E circuits.

Contact Us

For more information, pricing, or custom data center solutions, please contact us:

Website: <https://yoahorroenergia.es>

Email: hello@yoahorroenergia.es

Phone: +233 54 318 7269

Address: Plot 28, Spintex Road, Accra, Greater Accra, Ghana

This document is for informational purposes only. Specifications subject to change without notice.

