

# **Requirements for Fireproof Board Partitions for Cable Trays**



## Requirements for Fireproof Board Partitions for Cable Trays



Cable tray installation must comply with specific technical standards to ensure electrical safety, system reliability, and long-term maintainability. This document ...

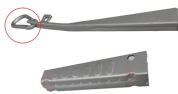

Design and install all piping, wiring or cable trays penetrating fire walls no more than 3 ft (0.9 m) from the floor. If the structural framework, including joists, beams and girders, has a fire resistance equal to ...



This guide explains the critical steps in fireproof cable trays acceptance, covering coating processes, inspection standards, and more. By following these steps, you can enhance durability ...



Cable tray installation must comply with specific technical standards to ensure electrical safety, system reliability, and long-term maintainability. This document outlines the key requirements for cable tray ...

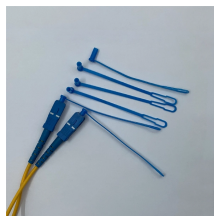

Provide non-curing, re-penetrable, intumescent firestop materials around communications cable trays or ladder racks penetrating through a fire rated wall. The firestop system assembly shall be able ...



1.1 This section applies to cable trays utilized to support and route low voltage cables (telecom, security, A/V). No fire alarm cables will be permitted to be installed in cable trays.



When selecting fire-blocking section materials, it is necessary to fully consider factors such as the type and purpose of the cable tray, fire-proof ...



The setting of fireproof bridge partitions should meet the following requirements: 1. Fire resistant bridge partitions should be made of non combustible materials such as gypsum board, mineral wool board, ...



3M Fire Barrier Moldable Putty+ is a one-part, halogen-free product designed to firestop electrical outlet boxes and a wide variety of through-penetrations including cable, conduit, insulated pipe and metal ...



Cable trays and busways at floor level or at slab penetrations shall have a waterstop no less than 50 mm in height. At slab penetrations, provide ...

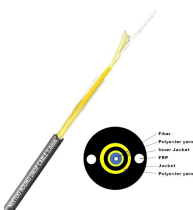

Cable trays and busways at floor level or at slab penetrations shall have a waterstop no less than 50 mm in height. At slab penetrations, provide 20-30 mm of firestopping and install a fire ...



When selecting fire-blocking section materials, it is necessary to fully consider factors such as the type and purpose of the cable tray, fire-proof performance and durability, construction ...



The supporting construction shall be protected to afford the required fire-resistance rating of the wall supported, except for tenant and guestroom separation walls and exit access corridor walls in ...

## Contact Us

For more information, pricing, or custom data center solutions, please contact us:

Website: <https://yoahorroenergia.es>

Email: [hello@yoahorroenergia.es](mailto:hello@yoahorroenergia.es)

Phone: +233 54 318 7269

Address: Plot 28, Spintex Road, Accra, Greater Accra, Ghana

This document is for informational purposes only. Specifications subject to change without notice.

